

The Land referred to herein below is situated in the County of Holmes, State of Ohio, and is described as follows:

Situated in the Township of Hardy, County of Holmes and State of Ohio:

Known as part of the Southeast Quarter of Section 15, Township 9 North and Range 6 West and being part of the lands conveyed to OH39 LLC by deed recorded in Official Record 273 at Page 7020 (AP #06-00935-000) and being more fully described as follows:

Beginning at a stone at the Northwest corner of the Southeast Quarter of Section 15; Thence South 85 deg. 00' 36" East, 563.91 feet along the quarter section line to a point,

Thence South 16 deg. 52' 51" West, 569.13 feet to a point in the center of U.S. 62 & S.R. 39;

Thence South 55 deg. 21' 19" East, 468.66 feet along the centerline of U.S. 62 & S.R. 39 to the point of beginning of the tract herein conveyed;

Thence continuing along the centerline of U.S. 62 & S.R. 39 the following 3 courses: South 56 deg. 22'25" East, 397.28 feet; South 58 deg. 22'25" East, 66.99 feet to a point of curvature; Thence along the arc of a curve to the left, having a radius of 2864.79 feet, a central angle of 11 deg. 04'57", a chord bearing and distance of South 63 deg. 54'55" East, 553.26 feet, an arc length of 554.12 feet to the intersection of the centerline of C.R. 623; Thence leaving Relocated U.S. 62 & S.R. 39 and with C.R. 623 the following 7 courses:

South 34 deg. 11'35" West, 69.45 feet;

South 43 deg. 17'35" West, 100.00 feet;

South 62 deg. 13'35" West, 100.00 feet to a pin set;

South 74 deg. 33'35" West, 100.00 feet to a pin set;

South 75 deg. 23'35" West, 200.00 feet;

South 77 deg. 01'35" West, 300.00 feet;

South 87 deg. 32'35" West, 15.00 feet.

Thence, leaving said centerline of C.R. 623, North 28 deg. 57'51" East, 299.64 feet to a point, said point being witness by a 1/2" iron rebar found 0.31 feet N.W. (On line) and passing a 1/2" iron rebar found on line at a distance of 37.42 feet, and a pin set at 40.68 feet; Thence North 59 deg. 26'59" West, 274.80 feet to a 1/2" iron rebar found; Thence North 08 deg. 14'59" East, 40.90 feet to a pin set; Thence North 00 deg. 52'07" West, passing a 1/2" iron rebar on line at a distance of 291.82 feet, and a 1/2" iron rebar on line at a distance of 300.21 feet, a total distance 378.01 feet to the Point of Beginning;

Containing within said bounds, 7.8101 acres (340,207 square feet), more or less, as surveyed by LMS Surveying, LTD. on March 6, 2020.

The meridian for all bearings shown hereon is N 77°01'35" E as the centerline line of C.R. 623 as described in O.R. Book 257, Page 6823 and Plat recorded in Plat Book 19 at Page 3078, Holmes County Records

The above legal description is a resurvey of and replaces the one contained in the immediate prior deed and others in its chain.

See Plat Volume 2; Page 616 for survey.

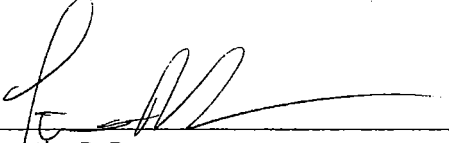

Timothy R. Durr
RPLS 7788
In the State of Ohio

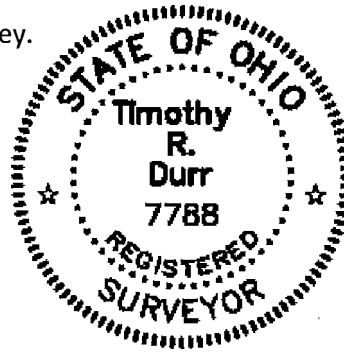

Parcel Number: 0600935001

FILE DESCRIPTION
Holmes County Map Office
3/16/2021

2 of 2