

Township 17th Range 14 Section 10 (Ripley)

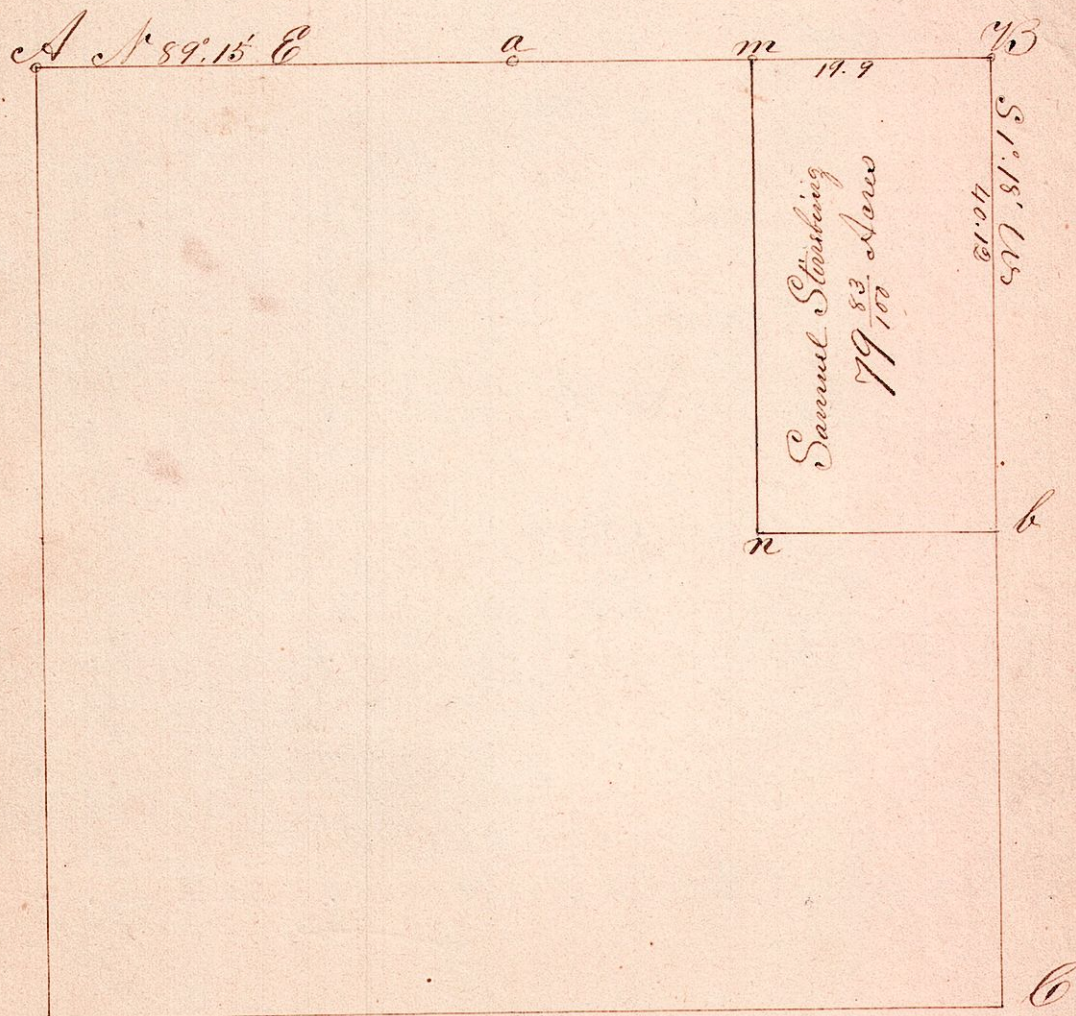

Field Notes of the above section

- A. B. Oak 12 N 35 $\frac{1}{2}$ ° E 74.8' N. Oak 14 S 72° W 94'
~~The stump~~ a. Witness timber not found, corner placed in middle
 B. Gum 13 S 65 $\frac{1}{2}$ ° W 171 links. Original not found
 n. N. Oak 16 S 24° E 8' S N. Oak 20 N 81 $\frac{1}{2}$ ° E 20 links

Remarks

The lines of the above section that are lettered were all that ~~were~~ surveyed.
 The witness timber at B was found though dead. At B none could be found & placed the corner by running cross lines—
 The corners on the East are recorded with section 11 joining on the East
 Surveyed January 1848

Jackson Silcott, Co. Sur