

Section 10 Range 5 in T⁸. eight.

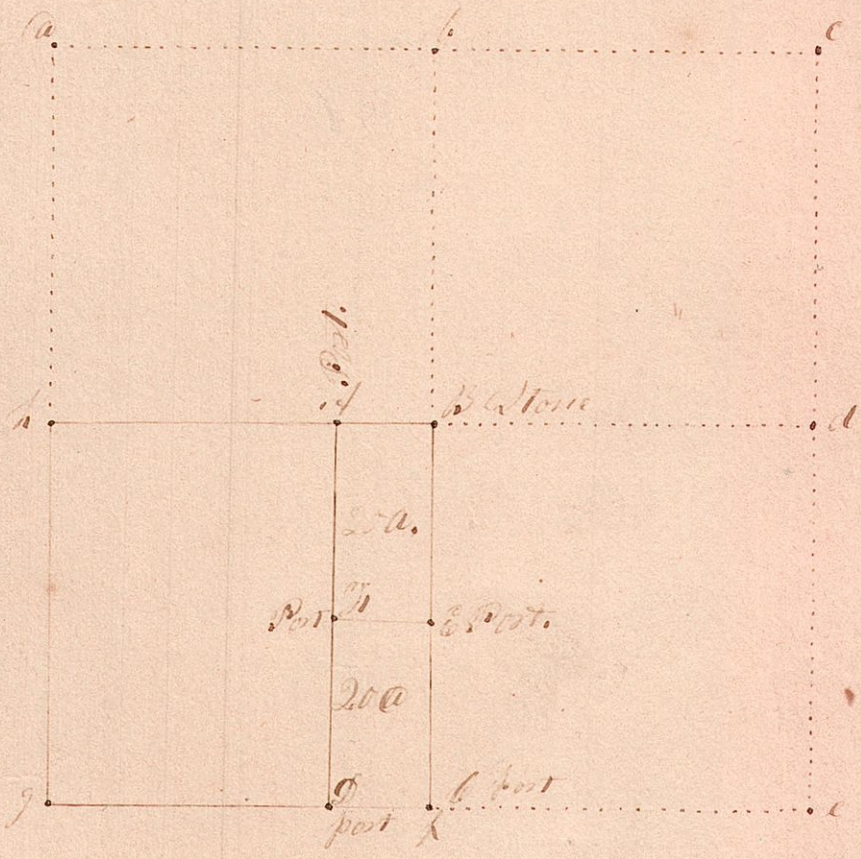

Surveyed the above September 1834

Being the east part of the South west quarter of Section ten in Range 5 of Township eight containing 40 acres.

9 a post the stump of one the original bearing tree yet standing. In a line started at a post N 60° E 12 S 52° E 50 links to W. Cab 11 S 15° E 122 one of the original D. to Cab 14 N 65° E 182 S to Cab 12 N 45° W 115 links.

J. S. Early, C. S. & Co.