

S. W. Trac of Sec 30 Tp 15, Range 12.

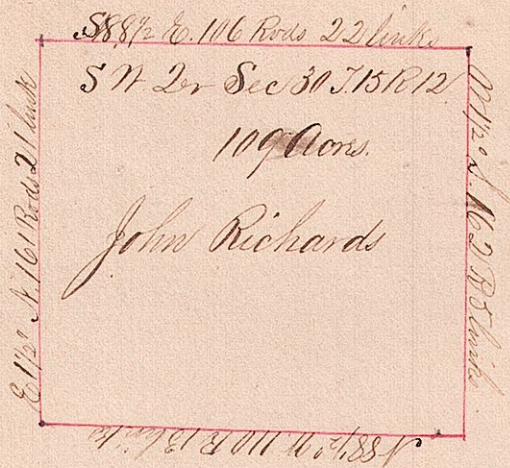

Surveyed for John Richards January 26th 1867.

Commenced at Stone at NE corner thence N 11 1/2° South 102 Rods 5 links
 to stake thence N 88 1/2° W 110 Rods 13 links to stake thence E 11 1/2° N 101 Rods
 21 links to stone, thence S 88 1/2° East 106 Rods 22 links, The above survey
was a surface survey mostly. Chainmen Andrew Knox and
 Henry Ober.

J. S. Orr County Surveyor