

CR 245

No. 72

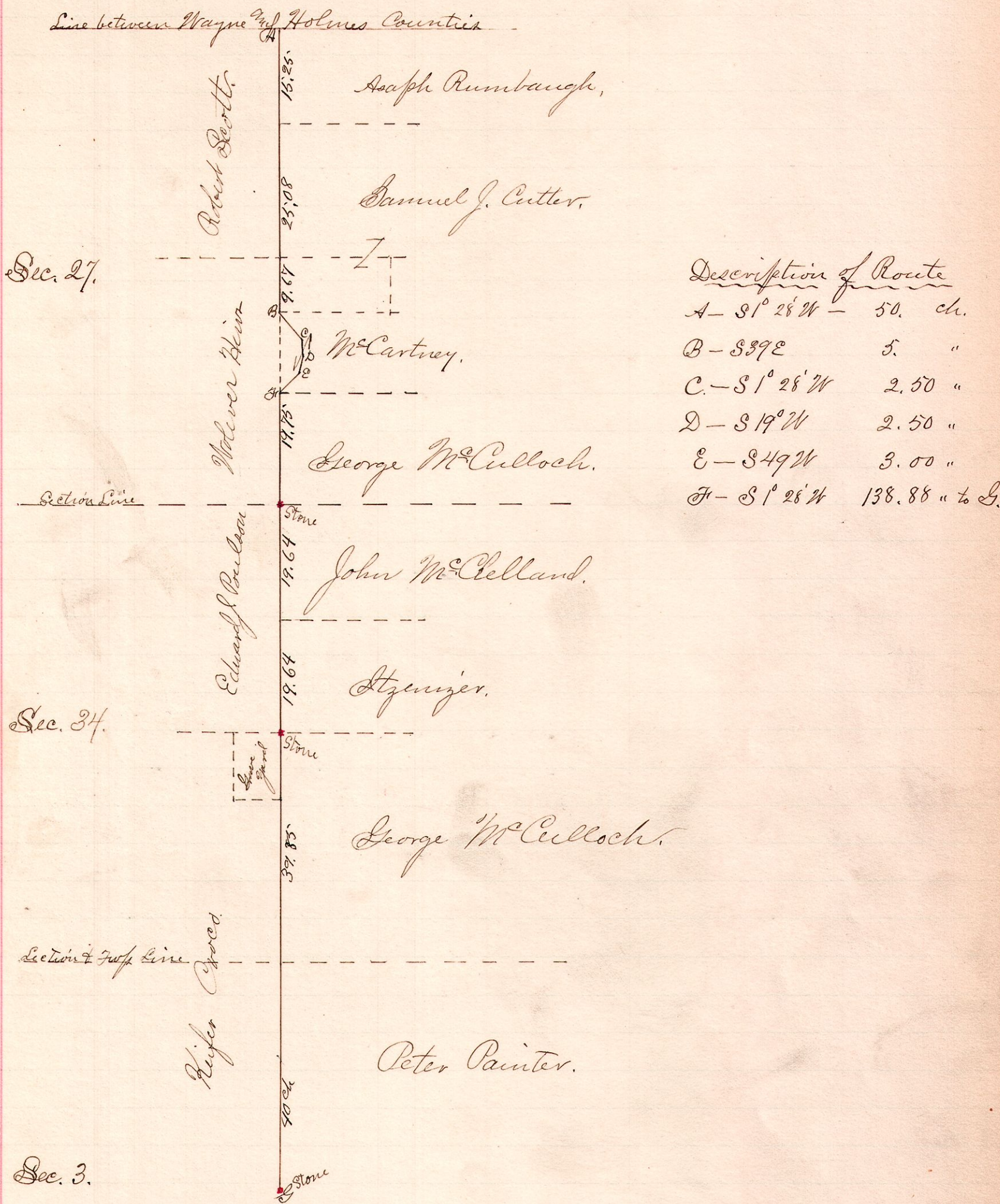

A survey made by order of the county Commissioners for the purpose of altering the width of a county road, established in 1831, 60 ft. wide to the width of 40 ft. said road beginning at the center of Sec 3, Twp. 13, R. 13 at a stone, then extending north through sections 34 & 27 of Twp. 14, Range 13 to the line between Holmes and Wayne counties and there to terminate

Principal Petitioner, John McClelland.

William Ditmars }
 Samuel Moreland } Viewers
 Milton Hanna }

Surveyed and Viewed September 13 & 14, 1887.

W. D. Hanna
 County Surveyor