

R Tp Sec Cr Pt
7 8 15 N8SW

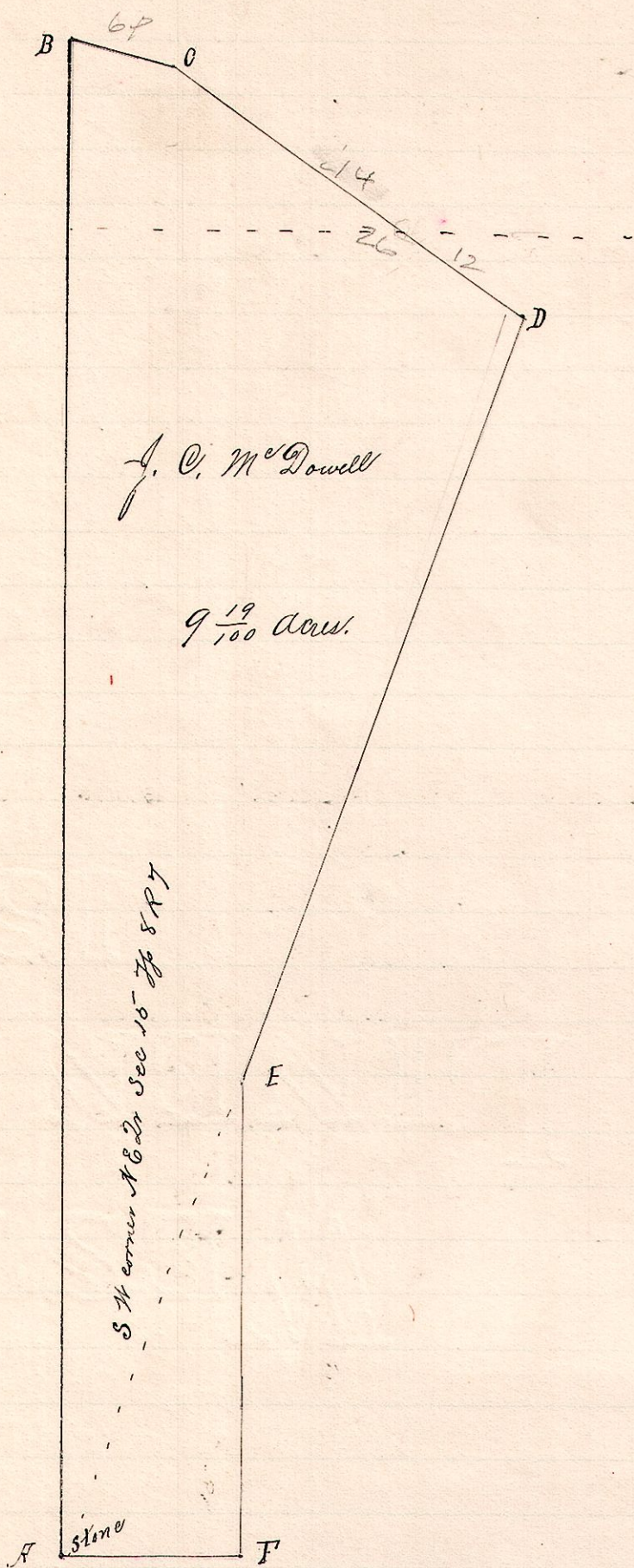

Notes

- "A" is a stone at the southwest corner of the northeast quarter of Section Fifteen (15) Township Eight (8), Range Seven (7).
- "B," a post on the west line of said quarter section, in the public road North $3\frac{1}{4}$ degrees East 91 perches 12 links from A.
- "C," a post in said road $S 73^\circ$ degrees east 6 perches from B.
- "D," a post in said road $S 57\frac{1}{2}^\circ$ degrees east 26 perches from C
- "E," a post $S 22^\circ$ degrees west 49 perches from D.
- "F," a post on south line of said quarter, South $3\frac{1}{4}$ degrees west of E, and 10 perches 17 links South $86\frac{3}{4}^\circ$ degrees east of A.

The broken line represented by B,C,D,E,A is along a public road

Surveyed the above to determine the line
Asa M. Chapman & Albert P. Chapman and J. C. McDowell
March 14, 1892.

Frank H. Genet,
County Surveyor,
Holmes Co. O.