

5.9.6

June 11th 1829, Surveyed Section 6 in in T9. of R5, in the following manner, and for the following persons.

W. Oak 24 N 27 E 32.
B. Oak 24 S 30 E 22.

W. Oak 30 S 44 E 17.
do 14 N 68 W 18.

W. Oak 15 S 84 W 26.
do 30 S 14 E 8.

Note. Martin Mamma two pieces must contain 250 acres.

Hickory 12 S 40 E 38.
B. Oak 26 N 28 E 34.

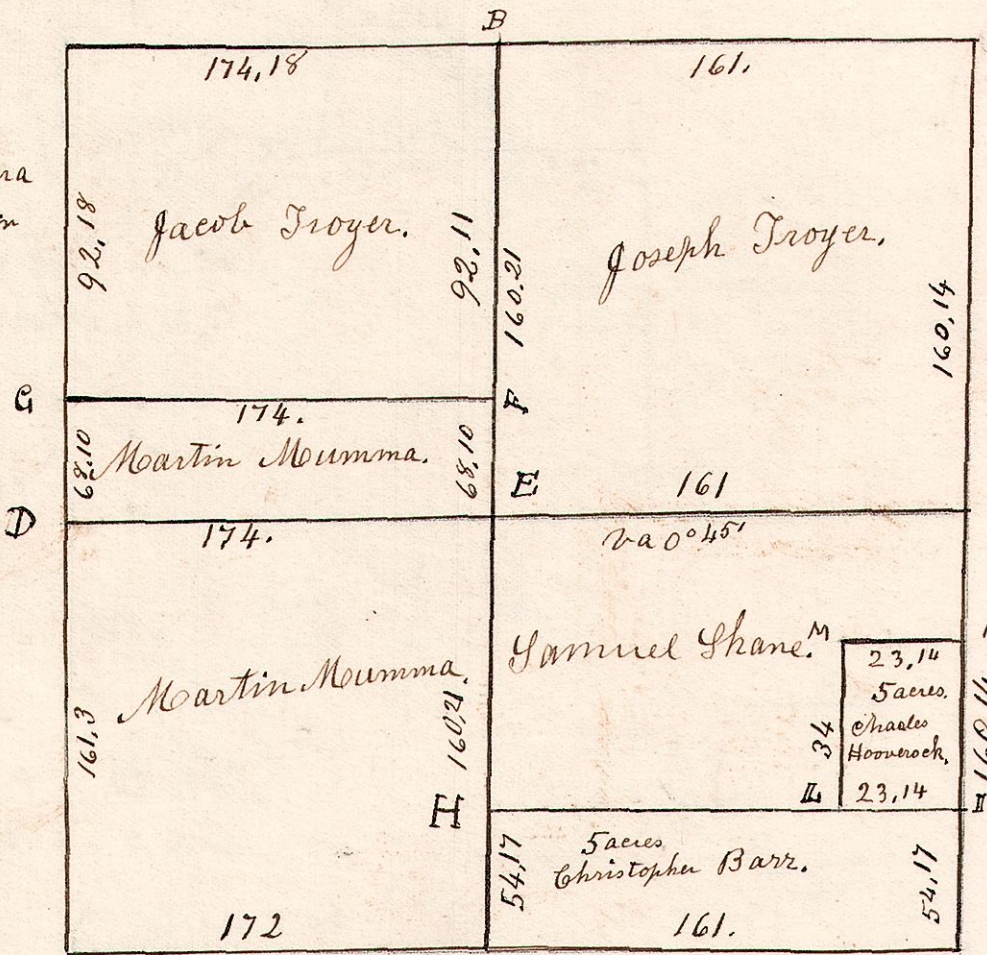

W. Oak 20 S 70 E 9.
do 28 S 82 W 28.

Hickory 12 S 40 E 38.
B. Oak 26 N 28 E 34.

W. Oak 16 N 45 W 22.
do 18 N 83 E 21.

Sugar tree 13 S 11 W 34.
d 13 N 55 E 42.

D	In Swamp.		
E	W. Oak	24	N 5 E 22 1/2
"	do	12	S 41 W 21 1/2
F	Dogwood	6	S 78 W 7 1/2
"	W. Oak	24	N 2 W 32
G	Elm	15	N 69 W 38
"	Ash	15	S 17 W 52
H	B. Oak	25	N 47 E 3
"	W. Oak	15	S 12 W 15

I	Gum	10	N 19 E 22
"	do	12	N 48 W 20
M	Ash	18	S 72 W 16
"	do	6	N 16 W 30
N	W. Oak	25	S 78 W 12
"	do	18	S 40 W 14
L	Maple	22	N 34 E 35
"	Elm	13	N 36 W 35

5.9.7.

S 7. T 9. R 5.

W. Oak 15 S 84 W 26.
Hickory 13 N 5 W 10
W. Oak 30 S 14 E 8

C W. Oak 20 S 70 E 9.
do 28 S 82 W 28.

E. R. Oak 24 S 6 W 25
Chestnut 23 N 72 E 34

F. W. Oak 20 S 89 W 33.
Hickory 12 N 26 W 22.

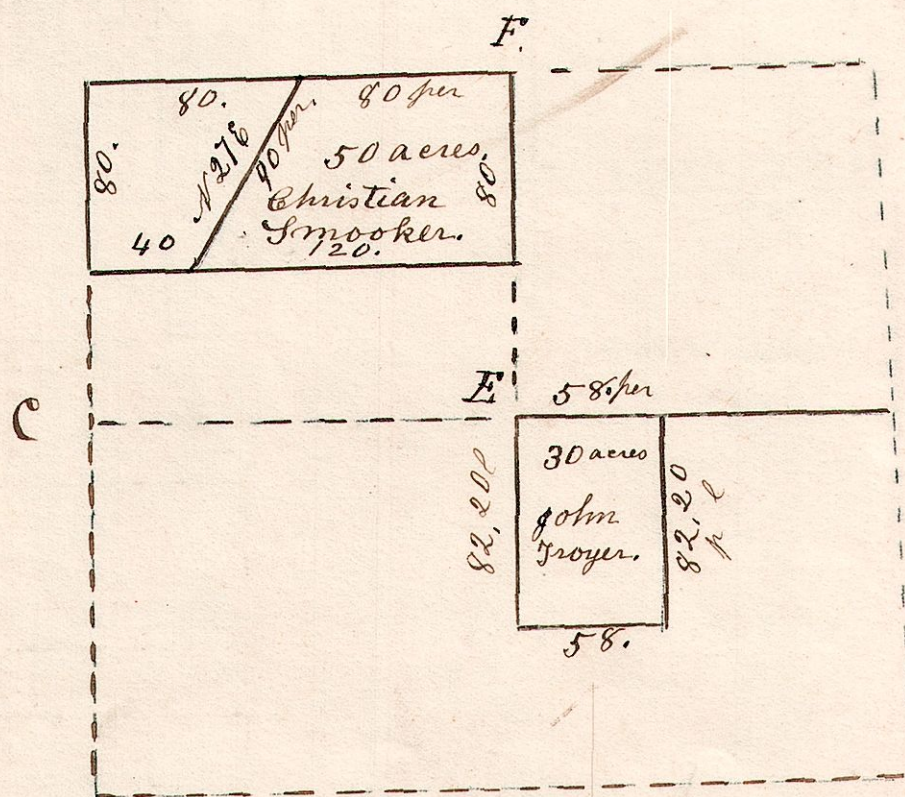

Surveyed the above pieces of land Nov 27th 1838. Situated in T 9. R 5. Sec 7.