

6. 9. 7. May 5th 1838

40.30

D.	W. Oak	16	S 34 W	11 1/2
"	Do	24	S 89 E	26.
C.	W Oak	20	S 63 W	9 1/2
"	Do	15	N 13 1/2 W	25
E.	W Oak	20	S 87 1/2 E	32 1/2
"	Beech	15	S 65 E	47.
B.	Hickory	12	S 40 W	17.
"	Sugar	9	S 43 E	6.
F.	Hickory	16	N 10 W	20.
"	Chestnut	12	S 3 W	5.
H.	Sassafras	7	N 54 E	7.
"	Maple	24	S 67 W	55.

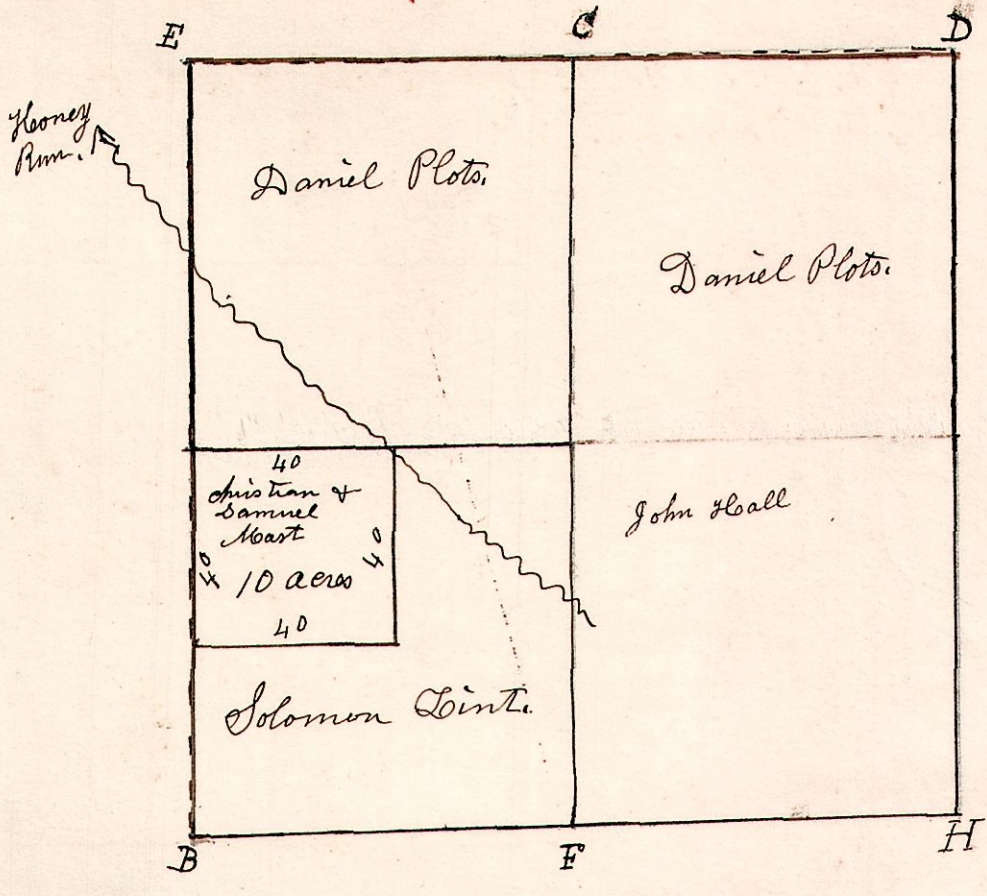

W 1/2 S. & E. qr of S 7. T 9 R 6.
 May 5th 1838 Surveyed the W 1/2
 of S & E qr of Sec 7 89 R 6.

6. 9. 23.

North west qr of Section 23 in Township 9. of Range 6.

April 23rd 1853.

W. Oak 24 N 4 1/2 E 33. B

Beech 15 N 82 W 33 1/2
 Do 10 S 86 1/2 E 12.1

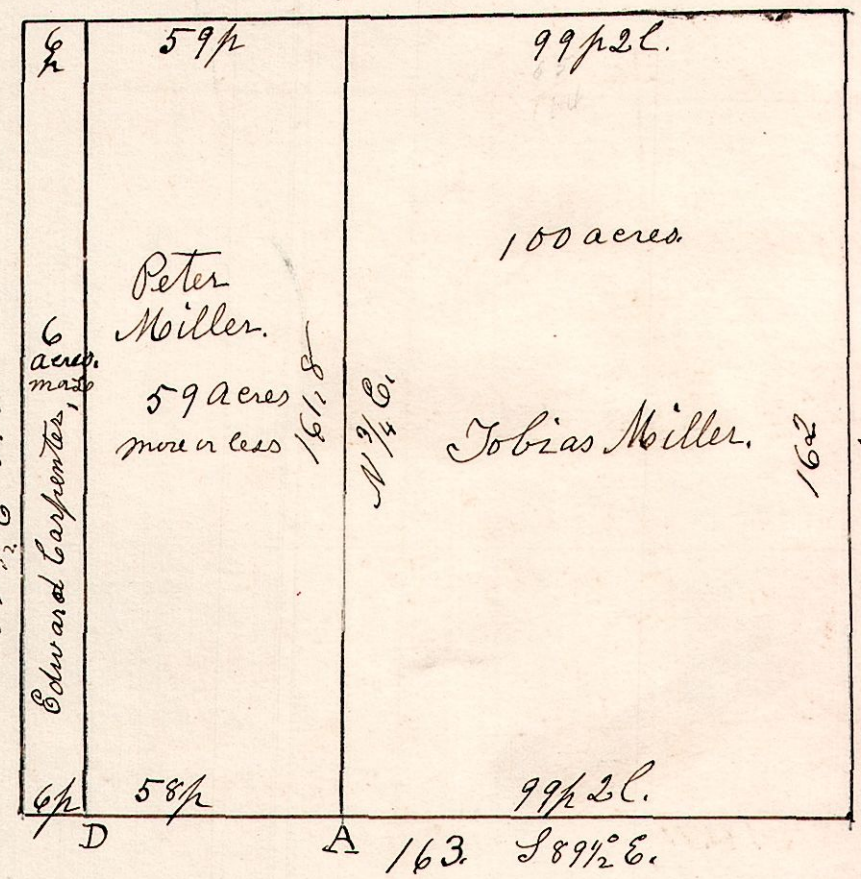

Beech 12 S 10 E 6.
 Dogwood 6 N 1/2 W 10.

A.	W oak	10	N 4 1/2 E	30
B.	Hickory	18	North	3
C.	W. Oak	18	N 31 E	16
D.	Chestnut	North		5