

6. 9. 14. S. E. q.

April 30th 1850.

YOUTH EAST QUARTER OF SECTION 14. S9. R6.
SURVEYED THE 100 ACRE TRACT.

See Surveys of 1833
(Page 200)

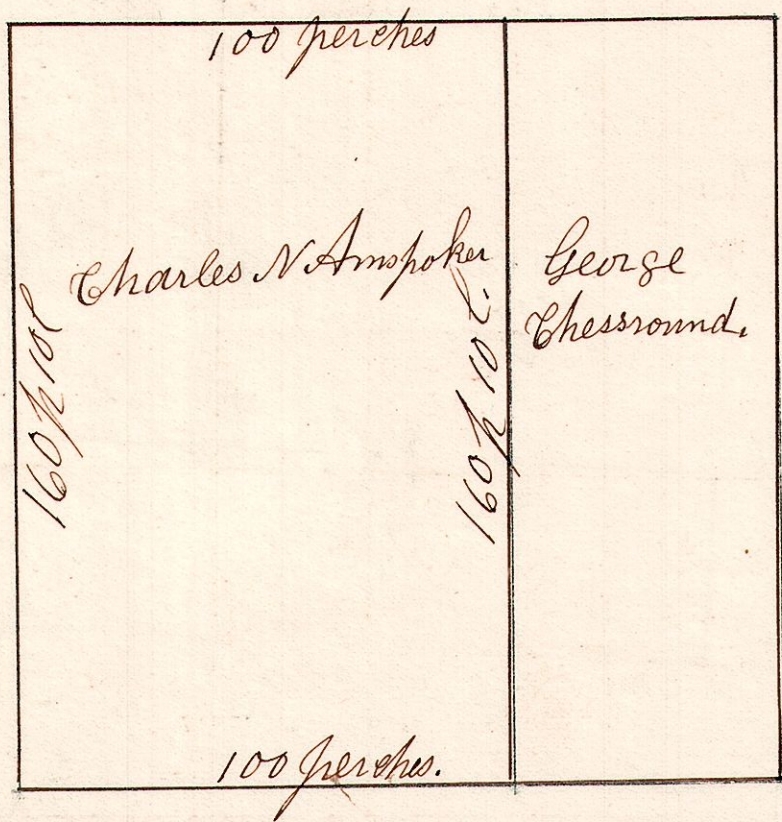

6. 9. 16. December 28th 1830.
SURVEYED SECTION 16. IN T^H 9. OF R. 6. IN THE
FOLLOWING MANNER AND FOR THE FOLLOWING PERSONS.

W. Oak 20. N46 E 10.
Do 14. S6W 36. D

W. Oak 36 N71 W 56.
Do 40 N65 E 43.

W. Oak 18 N5 E 27.
Maple 12 West 16. E

Dogwood 5. West 13.
Do 5. N33 E 16.

B. Ash 12. S72 E 6.
Do 12. S49 W 20.
W. Elm 13. N31 W 15.

W. Oak 14. S52 W 7.
Maple 16. N4 E 34.

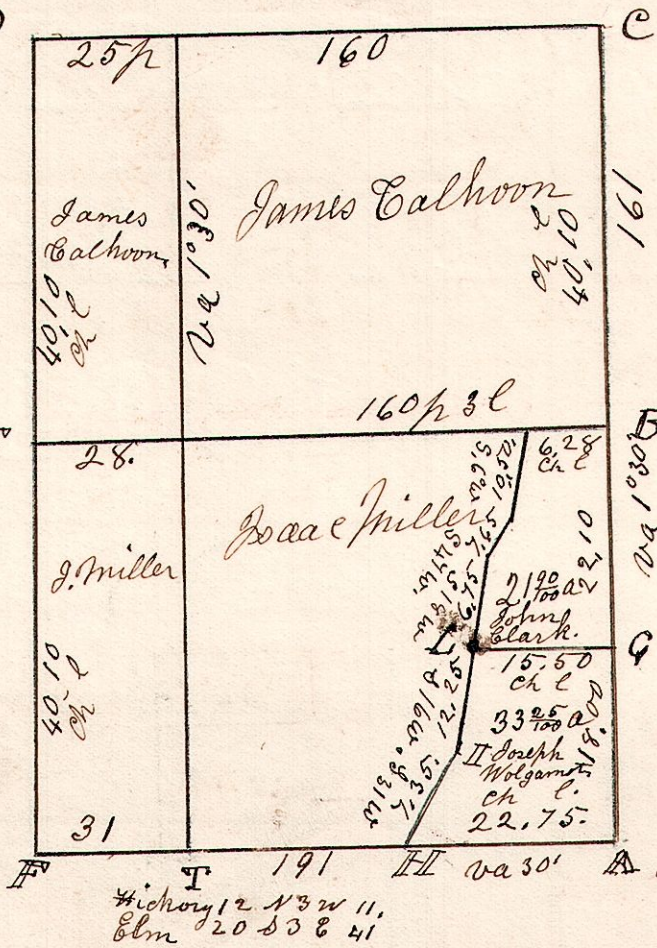

- H. Lynn 18. N22 W 12.
- I. Stone 12 the corner.
- L. Hickory 22. N15 E 4.
- G. Gum 8 N15 E 15.
- Do Do 7 S42 W 9
- P Stone 13 the corner.
- R. Stone 15 the corner.
- S. W. Oak 30 N82 W 29.
- U. Cherry 12 South 6.
- T Sugar 12 S41 W 39
- Do 8 S42 E 63