



L=61.24'
 R=2864.79'
 $\Delta=01^{\circ}13'29''$
 BRG=S 10°57'42" W
 C=61.24'

U.S. ROUTE NO 62 & STATE ROUTE NO. 83
 (HOL-62-30.629)
 AKA SOUTH WASHINGTON STREET

Leland J. & Charles A. Barnhart
 Deed V.127, P.513
 Highway Easement Rec.1, P.533

L=105.13'
 R=440.74'
 $\Delta=13^{\circ}40'00''$
 BRG=N 71°57'43" W
 C=104.88'

- △ denotes railroad spike (found)
- ▲ denotes railroad spike (set)
- denotes iron pin (found)
- denotes iron pin (set)

Bearings are oriented to the Investment Realty Properties, Ltd. tracts as described in O.R. 114, Page 237. Iron pins (set) are 30"x3/4" steel rod with plastic cap stamped D.A. Bower, #5753.

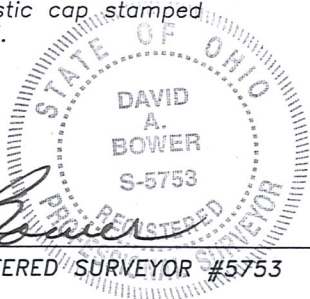

DAVID A. BOWER, REGISTERED SURVEYOR #5753

N 84°22'47" W
 530.00'
 CORP.
 SECTION 19
 S 84°22'47" E
 1342.10'
 Northeast corner
 Northeast Quarter
 Section 22

Millersburg Growth Company, Ltd.
 O.R.20, P.544

True Place
 of Beginning

S 10°21'00" W
 386.67'

56.35'

N 10°21'00" E
 259.78'

(0.825 ac. R/W)

Investment Realty Properties, Ltd.
 O.R.114, Page 237

3.695 ACRES

280.15'

S 79°39'00" E
 323.40'

297.89'

495.40'

S 06°41'45" W

197.51'

Reference used:
 O.R. 114, Page 237
 O.R. 20, Page 544
 Deed Volume 266, Page 798
 Survey Plat Volume 16, Page 921

N 65°08'31" W
 57.17'

N 78°46'15" W
 162.08'

COUNTY ROAD NO. 58 - 66' R/W
 LLWM Company Limited
 Deed V.266, P.798

R/W

169.92'

104.99'



SCALE: 1" = 100'		PLAT OF SURVEY	
SURVEYED:	JJG 1-10-02	GRANTOR: INVESTMENT REALTY PROPERTIES, LTD.	
DRAWN:	LDB 6-19-03	GRANTEE: INVESTMENT REALTY PROPERTIES, LTD.	
CHECKED:	DAB 6-19-03	LOCATION: PART OF THE NE QUARTER OF SECTION 22, TOWNSHIP 9, RANGE 7 VILLAGE OF MILLERSBURG, HOLMES COUNTY, OHIO	
REVISED DATE:	6-24-03	FILE ID:	MISC02-110
DIVERSIFIED ENGINEERING INC. New Philadelphia, Ohio		SHEET 1 OF 1	