

N^o 63

**MARTINS CREEK.
CEMETERY.**
HOLMES.CO. BERLIN. TWP.

OFFICIAL PROJECT NOS. 465-42-3-467
665-42-3-232

LEGEND	HISTORY
① REVOLUTIONARY WAR. PART OF ORIGINAL	
⑩ WAR OF 1812. U.S.MILITARY GRANT.	
⑮ WAR WITH MEXICO. CEM. ESTABLISHED	
⑲ CIVIL WAR. ABOUT 1870.	
⑳ SPANISH-AM. WAR.	
㉑ WORLD WAR.	

SCALE 20"=1" .28 ACRE

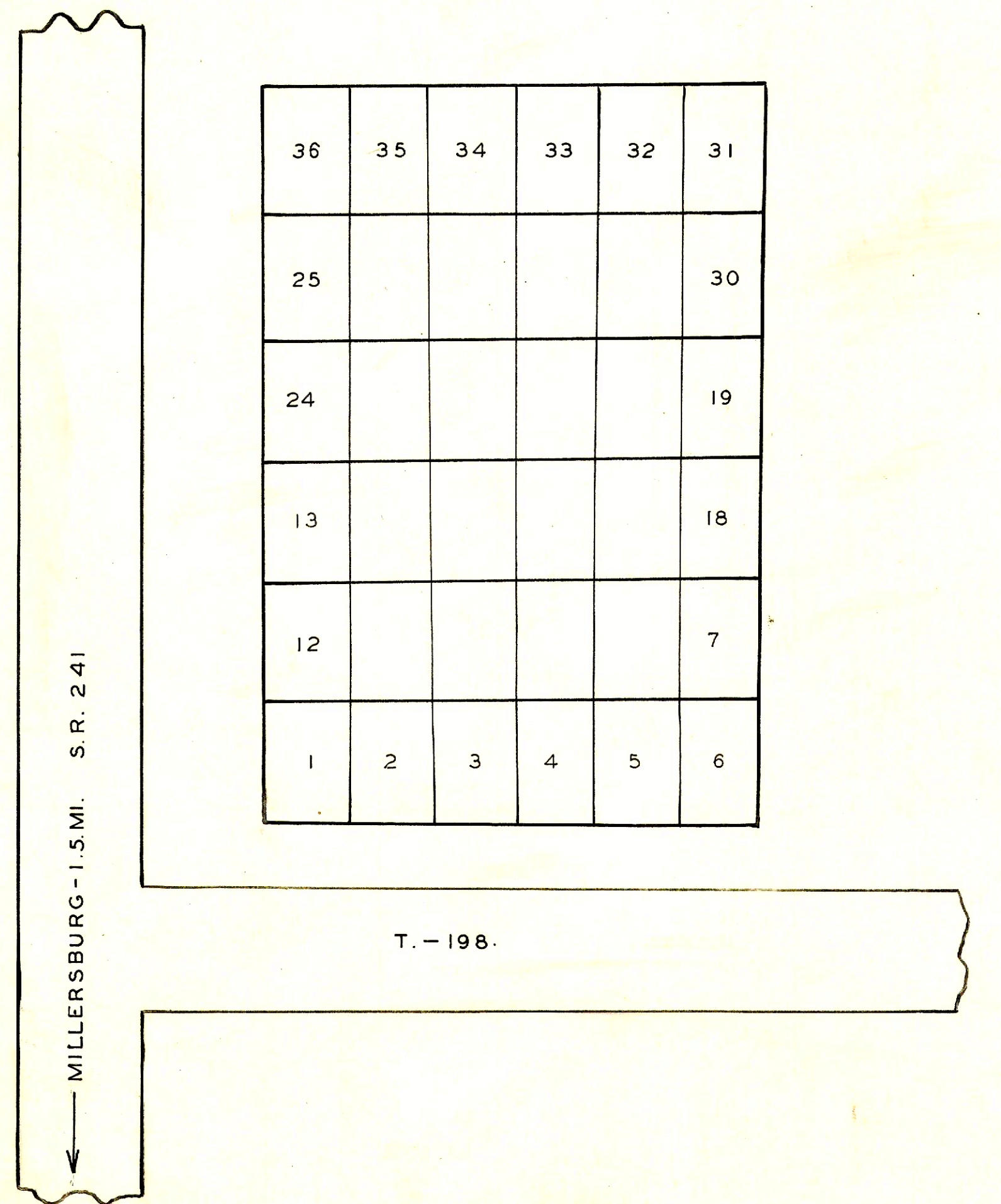

N^o 33

**GINDELSBERGER.
CEMETERY.**
HOLMES.CO. HARDY. TWP.

OFFICIAL PROJECT NOS. 465-42-3-467
665-42-3-232

LEGEND	HISTORY
① REVOLUTIONARY WAR. PART OF ORIGINAL	
⑩ WAR OF 1812. U.S.MILITARY GRANT.	
⑮ WAR WITH MEXICO. CEM. ESTABLISHED	
⑲ CIVIL WAR. ABOUT 1868.	
⑳ SPANISH-AM. WAR.	
㉑ WORLD WAR.	

SCALE 20"=1" .22 ACRE

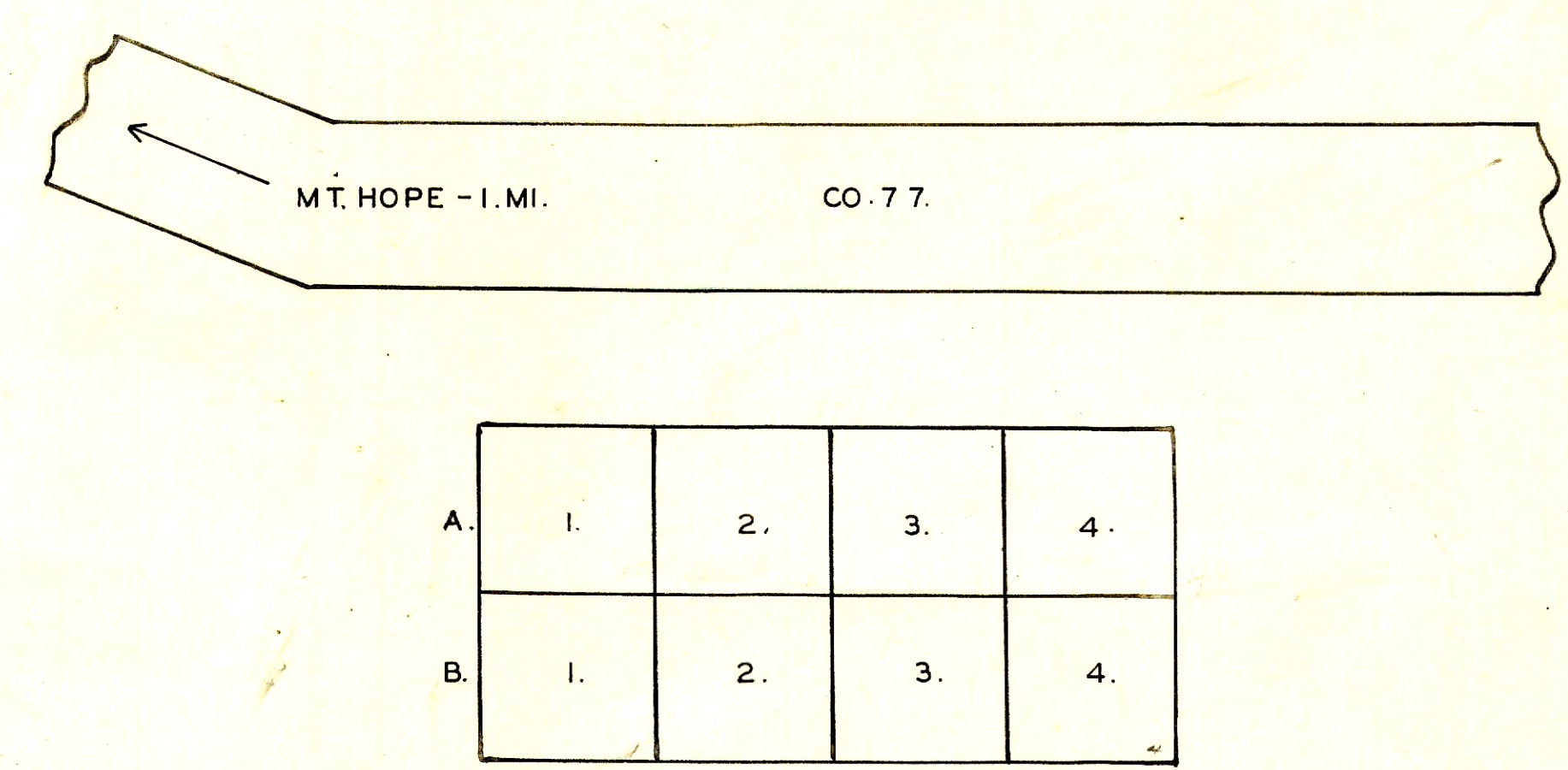

N^o 24

**DRUSHEL.
CEMETERY.**
HOLMES.CO. SALT CREEK. TWP.

OFFICIAL PROJECT NOS. 465-42-3-467
665-42-3-232

LEGEND	HISTORY
① REVOLUTIONARY WAR. PART OF ORIGINAL	
⑩ WAR OF 1812. U.S.MILITARY GRANT.	
⑮ WAR WITH MEXICO. CEM. ESTABLISHED	
⑲ CIVIL WAR. ABOUT 1864	
⑳ SPANISH-AM. WAR.	
㉑ WORLD WAR.	

SCALE 20"=1" .078 ACRE

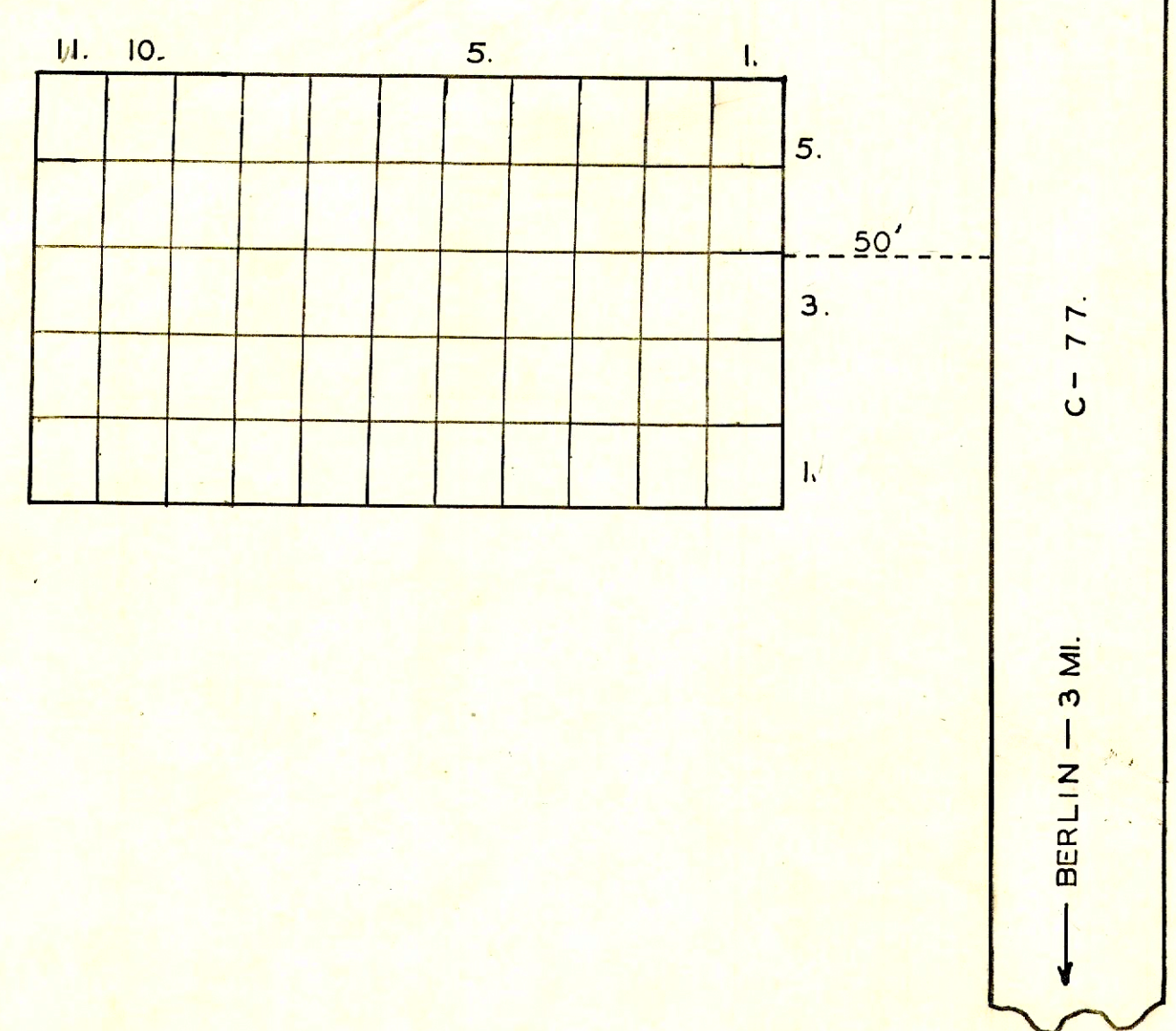

N^o 105

**JONAS RABER.
CEMETERY.**
HOLMES.CO. SALT CREEK. TWP.

OFFICIAL PROJECT NOS. 465-42-3-467
665-42-3-232

LEGEND	HISTORY
① REVOLUTIONARY WAR. PART OF ORIGINAL	
⑩ WAR OF 1812. U.S.MILITARY GRANT.	
⑮ WAR WITH MEXICO. CEM. ESTABLISHED	
⑲ CIVIL WAR. ABOUT 1880.	
⑳ SPANISH-AM. WAR.	
㉑ WORLD WAR.	

SCALE 20"=1" .1 ACRE